

CONSTRUCTION AS PER ASME SECTION VIII
 MAX WORKING PRESSURE: 150 PSI
 HYDROTEST PRESSURE 205 PSI
 MAX TEMP: 250°F MIN TEMP: -20°F
 MATERIAL IS 316SS

PARTS LIST			
ITEM	QTY	PART NUMBER	DESCRIPTION
1	1	Central Body	8" Pipe 316SS
2	1	Bottom Cap	8" ANSI 316SS CAP
3	1	Top Flange with Seal	1" Plate 316SS
4	2	ASME B16.5 3"-150# RFSO	Inlet and Outlet Flanges
5	1	Strainer Top Cover w/integral cap for flow redirection	316SS 1" Plate with integral Cap
6	2	1/2" NPTF Threaded Coupling 316SS	Vent and Inlet Drain Connections
7	1	Stand	3 Leg Stand for Housing Positioning

SECTION A-A
 SCALE 0.3

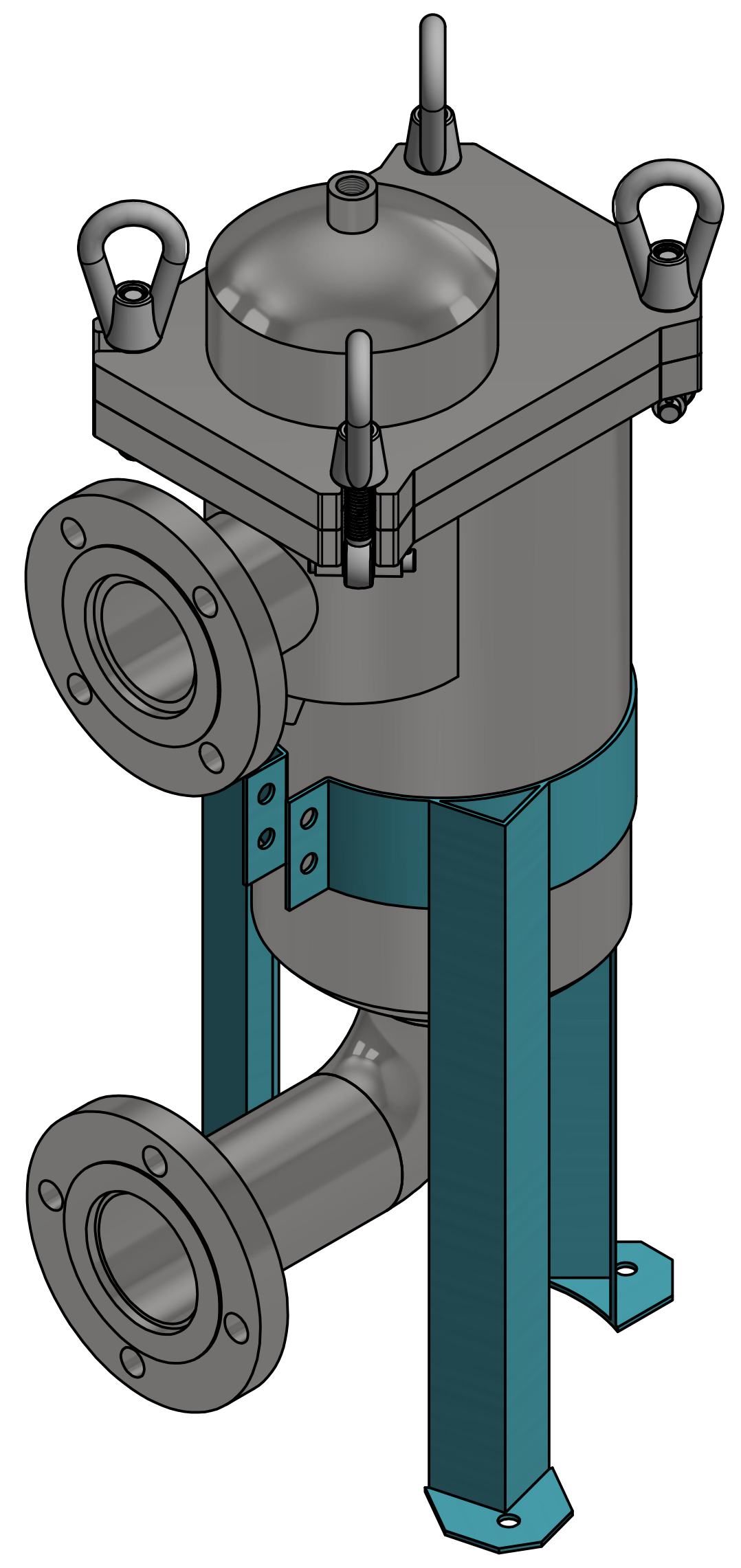
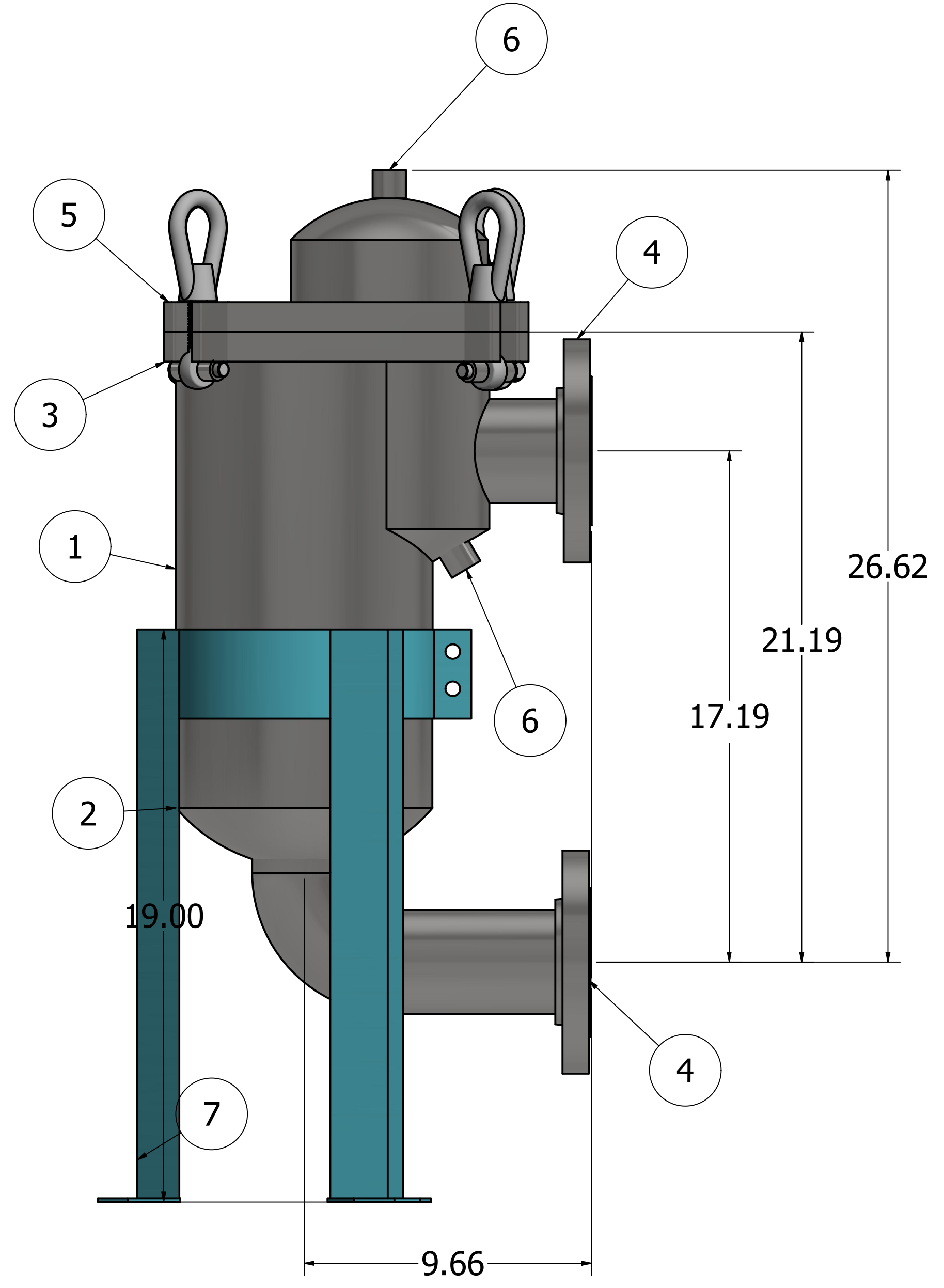
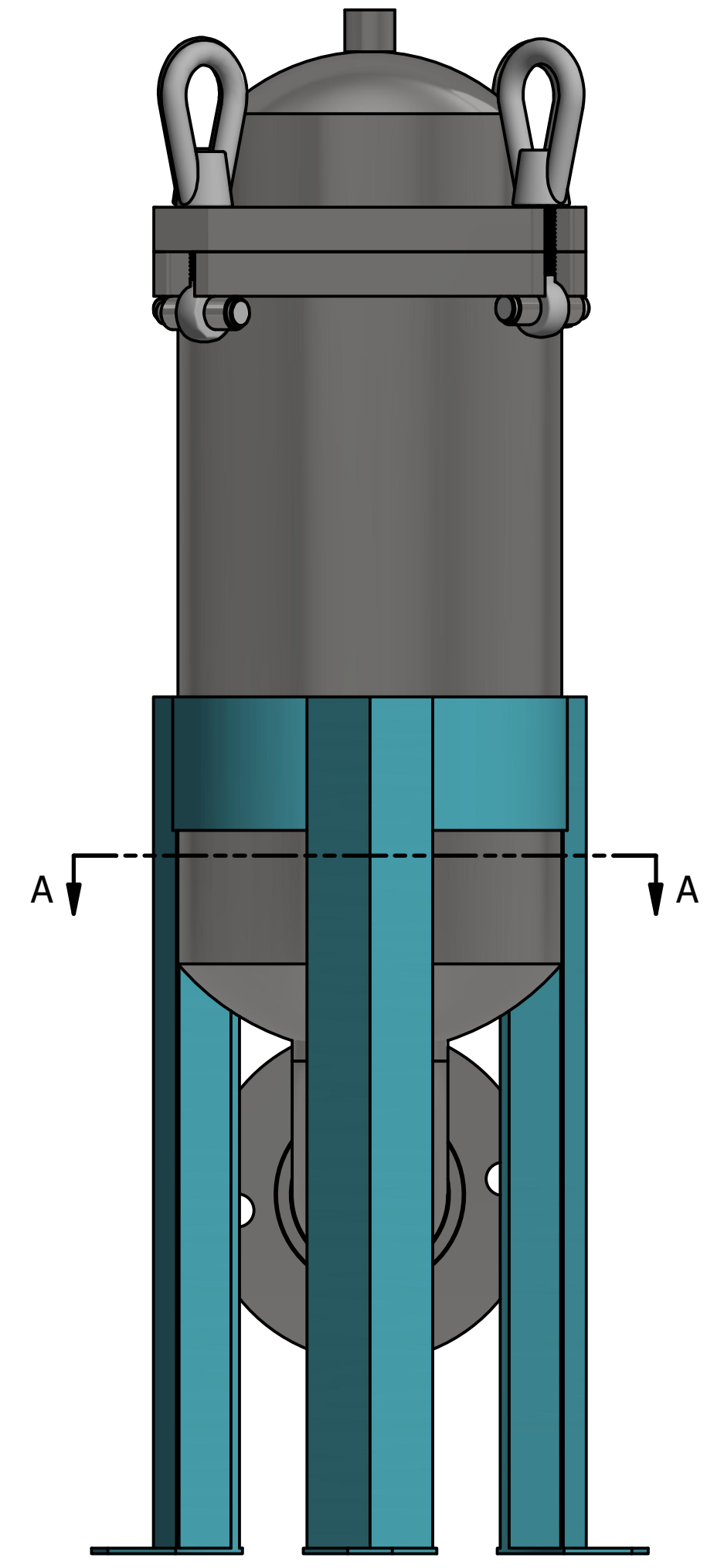

DRAWN A SUBERO	12/16/2021	FLUID FILTRATION MFG CORP	
CHECKED		TITLE	
QA		FILTER ASSEMBLY	
MFG		SIDE IN - BOTTOM OUT	
APPROVED		FF.PR.3.0.150.316SS.#1 BAG FILTER	
		SIZE D	DWG NO FF.PR.3.0.150.1.SIBO.RF
		SCALE 0.3	REV SHEET 1 OF 1